

WICTEC EL60

Unitised curtain wall

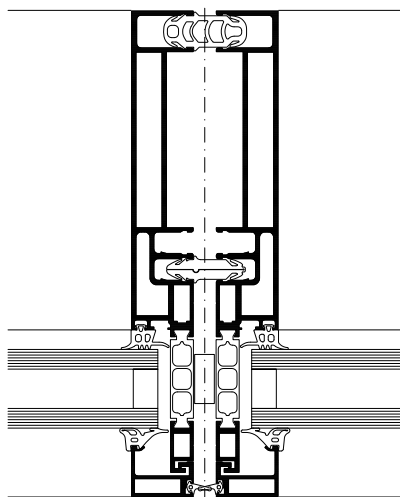

WICTEC EL60 is the slim version within the unitised curtain wall systems, with especially reduced sight lines of just 60 mm both inside and outside. The exterior glazing profiles with mitre joints achieve a particularly elegant appearance with a “picture frame effect”. As a result of optimised thermal insulation, the system leads the way with outstanding U_{cw} values of up to $0.9 \text{ W}/(\text{m}^2\text{K})$.



System test results / CE product pass in accordance with DIN EN 13830

Air permeability:	Class AE
Watertightness:	RE 1200
Resistance to wind load:	2000 / -3200 Pa, security 3000 / -4800 Pa
Impact resistance:	Class E5 / I5
Quality assurance:	Certified according to ISO 9001:2008

Technical performance:

System width:	60 mm
Profile depth:	198 mm
Thermal insulation:	U_f for support and bar profiles up to $1.6 \text{ W}/(\text{m}^2\text{K})$ U_f for frame combinations up to $1.8 \text{ W}/(\text{m}^2\text{K})$ U_{cw} up to $0.9 \text{ W}/(\text{m}^2\text{K})$
Infill thickness:	Up to 36 mm as standard system, above on request
Unit sizes:	(w x h) up to 2800 mm x 3500 mm, up to 1500 mm width without mid posts

System technology:

- WICTEC EL60 is a basic unitised system and can be adapted individually to meet specific project requirement
- Production of the complete units in the workshops, avoiding any weather influence and thus assuring a constantly high product quality
- Fast, efficient and projectable assembly on site
- Aluminium composite profiles with excellent thermal insulation, from quality-assured and monitored production
- Slim sight lines of only 60 mm, with divided and undivided profiles
- Mullions and transoms have the same profile depth
- Reliable corner connection with corner brackets
- On the construction site, the units are easily installed in the façade anchors from the system range

