

» WICLINE 65 evo / 75 evo
Integration sash, outward
opening, Top-hung
sash / Side-hung sash

A sash opening towards the outside offers many substantial advantages like effective ventilation, the choice between manual and motorised operation, and avoids a disturbing sash towards the inside. With large sash dimensions available and optimised functionality WICLINE evo offers an interesting alternative opening type for architecture.

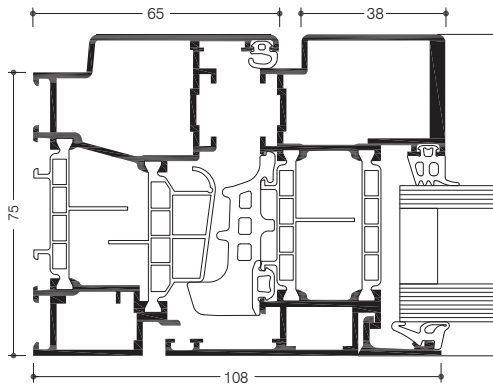

System test results / CE product pass in accordance with DIN EN 14351-1:2006+A1:2010

Air permeability:	Class 4
Watertightness:	E1200
Resistance to wind load:	Class C5 / B5
Operating forces:	Class 1
Load bearing capacity of safety devices:	Fulfilled
Mechanical strength:	Class 4
Repeated opening / closing:	Class 2 (10 000 cycles)
Impact resistance:	Class 3
Quality assurance:	Certified according to ISO 9001:2008
Environmental management:	Certified according to ISO 14001

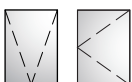

Technical performance:

Profile technology:

- High insulation multi-chamber system in symmetric design, quality assured thermal insulator connection
- Patented corner and butt joint connection technology for high rigidity of frames and sashes
- Infill thickness up to 69 mm
- Optionally with frame for punched hole application

Thermal insulation:

- U_f values until 1.5 W/(m²K)
- U_w values until 0.94 W/(m²K)

Sealing concept:

- Special multi-chamber centre gasket with fins for superior tightness and improved thermal insulation

Hardware:

- Externally applied turn hinges, optionally with
 - top fixation for top-hung opening
 - lateral fixation for side-hung opening
- Operation either manual or motorised
- Sash weight until 150 kg
- Sash sizes (w x h): until 2000 mm x 2000 mm

