

WICLINE 65 evo / WICLINE 75 evo

Integration pivot sash, horizontal or vertical

A classic opening type becomes again a state-of-the-art product with WICONA technology: The horizontal and the vertical pivot windows based on the aluminium window system WICLINE evo offer improved thermal insulation, have achieved high classifications in CE-testing each, and with their option of visible or concealed fittings they are a real visual highlight for any façade integration.

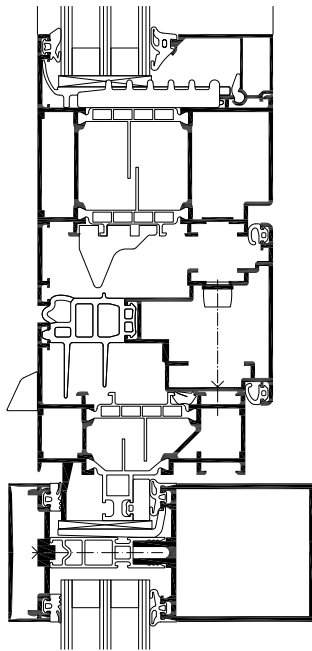

System test results / CE product pass in accordance with DIN EN 14351-1:2006+A1:2010

	Horizontal	Vertical
Air permeability:	Class 4	Class 4
Watertightness:	E750	4A
Resistance to wind load:	Class C5 / B5	Class C5 / B5
Operating forces:	Class 1	Class 1
Mechanical strength:	Class 4	Class 4
Repeated opening / closing:	Class 2 (10,000 cycles)	Class 2 (10,000 cycles)
Quality assurance:	Certified according to ISO 9001:2008	



Technical performance:

Profile technology:

- High insulation multi-chamber system in symmetric design, quality assured thermal insulator connection
- Patented corner and butt joint connection technology for high rigidity of frames and sashes
- Infill thickness up to 69 mm
- Optionally with frame for punched hole application

Thermal insulation:

- U_f values: until 1.5 W/(m²K)
- U_w values: until 1.0 W/(m²K) with triple glazing

Sealing concept:

- Special multi-chamber centre gasket with fins for superior tightness and improved thermal insulation

Fittings:

- Horizontal or vertical pivot fittings, optionally with
 - visible bearings or
 - concealed bearings
- Sash weight:
 - Horizontal: up to 150 kg
 - Vertical: up to 120 kg
- Sash formats (w x h):
 - Horizontal: up to 2400 mm x 1400 mm
 - Vertical: up to 2000 mm x 2000 mm

