

WICLINE 65 evo /  
WICLINE 75 evo Integration sash,  
outward opening, Top-hung  
sash / side-hung sash

A sash opening towards the outside offers many substantial advantages like effective ventilation, the choice between manual and motorised operation, and avoids a disturbing sash towards the inside. With very big possible sash dimensions and optimised functionality WICLINE evo offers an interesting alternative opening type for architecture.

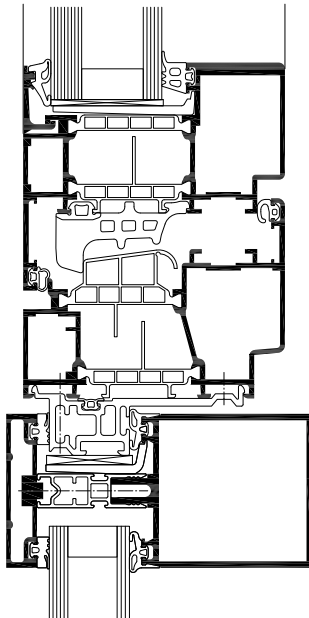

**System test results / CE product pass in accordance with DIN EN 14351-1:2006+A1:2010**

Air permeability:	Class 4
Watertightness:	E1200
Resistance to wind load:	Class C5 / B5
Operating forces:	Class 1
Load bearing capacity of safety devices:	Fulfilled
Mechanical strength:	Class 4
Repeated opening / closing:	Class 2 (10,000 cycles)
Impact resistance:	Class 3
Quality assurance:	Certified according to ISO 9001:2008



**Technical performance:**

**Profile technology:**

- High insulation multi-chamber system in symmetric design, quality assured thermal insulator connection
- Patented corner and butt joint connection technology for high rigidity of frames and sashes
- Infill thickness up to 69 mm
- Optionally with frame for punched hole application

**Thermal insulation:**

- $U_f$  values until 1.5 W/(m<sup>2</sup>K)
- $U_w$  values until 0.94 W/(m<sup>2</sup>K)

**Sealing concept:**

- Special multi-chamber centre gasket with fins for superior tightness and improved thermal insulation

**Fittings:**

- Externally applied turn hinges, optionally with
  - top fixation for top-hung opening
  - lateral fixation for side-hung opening
- Operation either manual or motorised
- Sash weight until 150 kg
- Sash sizes (w x h): until 2000 mm x 2000 mm

