

# WICTEC 50EL

## Unitised curtain wall

WICTEC 50EL is a unitised version of the WICTEC 50 stick system. This range combines the advantages of the stick system structure with the assembly benefits of unitised curtain walling, with an extremely narrow sight line of only 50 or 65 mm. The exterior profiles with mitre joints on the outside achieve a particularly elegant appearance with a "picture frame effect". Particularly where there are stringent requirements pertaining to thermal insulation, WICTEC 50 EL offers the appropriate solution.

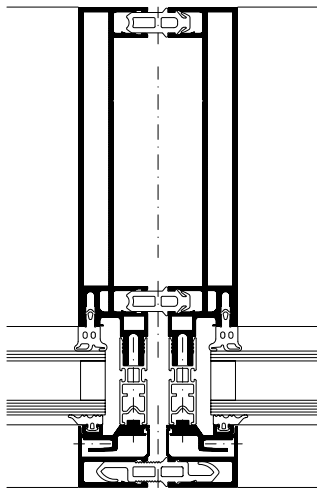

### System test results / CE product pass in accordance with DIN EN 13830

Air permeability:	Class AE
Watertightness:	RE 1200
Resistance to wind load:	2000 / -3200 Pa, security 3000 / -4800 Pa
Impact resistance:	Class E5 / I5
Quality assurance:	Certified according to ISO 9001:2008



### Technical performance:

System width:	50 mm for undivided frames 65 mm for divided frames
Profile depth:	195 mm to 213 mm, depending on the infill 130 mm inner profile elevation
Thermal insulation:	$U_i$ up to 1.4 W/(m <sup>2</sup> K) at horizontal bar $U_i$ up to 1.5 W/(m <sup>2</sup> K) at vertical bar
Infill thickness:	up to 44 mm
Unit sizes:	(w x h) up to 3000 mm x 3500 mm, up to 1500 mm width without mid posts

### System technology:

- WICTEC 50EL is a basic unitised system and can be adapted individually to meet specific project requirements
- Production of the complete units in the workshops, avoiding any weather influence and thus assuring a constantly high product quality
- Fast, efficient and projectable assembly on site
- Aluminium profiles using mullion-transom technology, with insulating profile that provides a high level of thermal insulation
- Narrow sight lines for maximum transparency
- Mullions and transoms have the same profile depth
- Efficient thermal protection up to  $U_i = 1.4$  W/(m<sup>2</sup>K)
- Reliable corner connection with system brackets
- Easy installation on the construction site, with special system anchors

