

WICLINE 65 evo/ WICLINE 75 evo Italian window (outward)

An elegant appearance combined with efficient ventilation are the characteristics of the aluminium system WICLINE evo in its Italian opening version. Concealed friction stays ensure an outward opening also for large size sashes, with a secure opening fixation in any position. Special frame profiles for punched windows or for curtain wall integration as well as a large selection of friction stay sizes guarantee maximum versatility of the system.

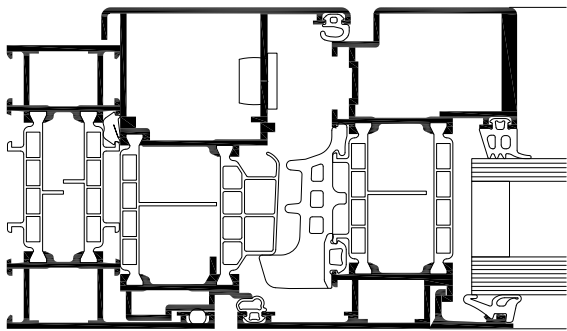

System test results/CE product pass in accordance with DIN EN 14351-1:2006+A1:2010

| | |
|---------------------------|--------------------------------------|
| Air permeability: | Class 4 |
| Watertightness: | E1200 |
| Resistance to wind load: | Class C5/B5 |
| Operating forces: | Class 1 |
| Mechanical strength: | Class 4 |
| Repeated opening/closing: | Class 2 (10,000 cycles) |
| Impact resistance: | Class 3 |
| Quality assurance: | Certified according to ISO 9001:2008 |



Technical performance:

Profile technology:

- High insulation multi-chamber system in symmetric design, quality assured thermal insulator connection
- Patented corner and butt joint connection technology for high rigidity of frames and sashes
- Infill thickness up to 69 mm
- Optionally with integration frame for stick system curtain walls

Thermal insulation:

- U_f values: until 1.5 W/(m²K)
- U_w values: until 1.0 W/(m²K) with triple glazing

Sealing concept:

- Voluminous centre gasket with formed corners

Fittings:

- Concealed integrated friction stay fittings, with vertical adjustment
- Operation either manual or motorised
- Sash weight: until 150 kg
- Sash formats (w x h): until 2000 mm x 2200 mm