

WICLINE 65 evo / WICLINE 75 evo Top-hung / Side-hung window (outward)

The outward opening function frequently offers substantial benefits: efficient ventilation, no disturbing sash in the room, manual or motorised operation. With its very large sash formats and optimised functions WICLINE evo features in this option a more than interesting alternative for architecture.

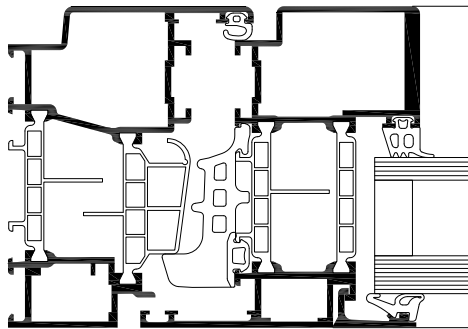

System test results / CE product pass in accordance with DIN EN 14351-1:2006+A1:2010

Air permeability:	Class 4
Watertightness:	E1200
Resistance to wind load:	Class C5/B5
Operating forces:	Class 1
Load bearing capacity of safety devices:	Fulfilled
Mechanical strength:	Class 4
Repeated opening/closing:	Class 2 (10,000 cycles)
Impact resistance:	Class 3
Quality assurance:	Certified according to ISO 9001:2008

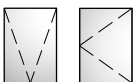

Technical performance:

Profile technology:

- High insulation multi-chamber system in symmetric design, quality assured thermal insulator connection
- Patented corner and butt joint connection technology for high rigidity of frames and sashes
- Infill thickness up to 69 mm
- Optionally with integration frame for stick system curtain walls

Thermal insulation:

- U_f values: until 1.5 W/(m²K)
- U_w values: until 0.94 W/(m²K) with triple glazing

Sealing concept:

- Voluminous centre gasket with three installation methods
 - Circumferential centre gasket, avoiding joints in the corner areas
 - Formed corners, avoiding adhesive in the joints
 - Corner vulcanised frames

Fittings:

- Exterior visible turn fittings, optionally:
 - top-side application for top-hung opening
 - lateral application for side-hung opening
- Operation either manual or motorised
- Sash weight: up to 150 kg
- Sash formats (w x h): up to 2000 mm x 2000 mm

