

WICLINE 75FP

Fire protection window



The new WICLINE 75FP fire protection window completes the WICONA fire protection portfolio. The design is based 100 % on the WICLINE window series and does not change in the design from the standard application.

The single sash fire protection opening unit can be applied as punched hole window, as window with surrounding, as fixed glazing or integrated in a WICTEC 50FP fire protection stick curtain wall.

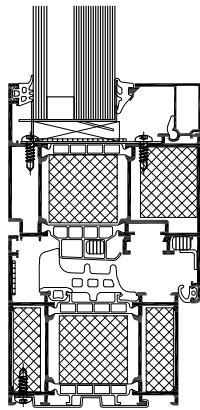

System test results / CE product pass in accordance with DIN EN 14351-1:2006+A1:2010

Air permeability:	Class 4
Watertightness:	E750
Resistance to wind load:	Class C4 / B4
Operating forces:	Class 2
Load bearing capacity of safety devices:	Fulfilled
Mechanical strength:	Class 4
Repeated opening / closing:	Class 2 (10,000 cycles)
Impact resistance:	Class 3
Quality assurance:	Certified according to ISO 9001:2008



Technical performance:

Profile technology:

- National technical approval: please contact the WICONA sales office
- Tested according to the standard DIN EN 1634
- Execution in fire protection classes EI30 or EW30
- Patented corner and butt joint connection technology for high rigidity of frames and sashes
- Infill thickness up to 43 mm
- Optionally with integration frame for stick curtain walls

Thermal insulation:

- U_f values: until 1.6 W/(m²K)

Sealing concept:

- Voluminous centre gasket with three installation methods
 - Circumferential centre gasket, avoiding joints in the corner areas
 - Formed corners, avoiding adhesive in the joints
 - Corner vulcanised frames

Fittings:

- Heavy duty system fittings, with concealed hinges, integrated end position damping, opening angle max. 105°
- Sash weight:
 - Concealed fittings: up to 160 kg
- Sash sizes (w x h): 1170 mm x 2170 mm

