

WICLINE

Window systems

Burglar resistance

Personal security and building protection – for your building you need a solution approach which can be accomplished with aluminium systems in a holistic and compatible way. This is achieved by the WICONA series for windows, curtain walls and doors. Each of them can be executed in burglar resistance, in combination with other additional functions. The various levels of resistance classes can be achieved with all WICLINE window series without visual alterations of the constructions, with only a minimum of additional measures on the basis of the standard design.

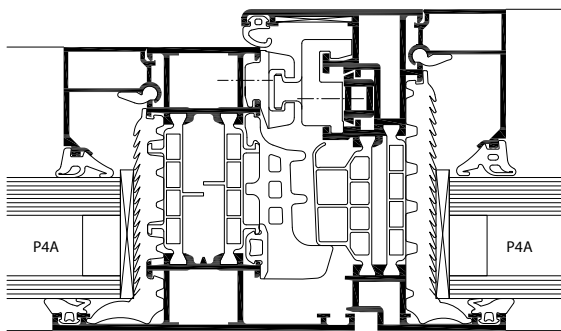

WICLINE 75 evo RC2

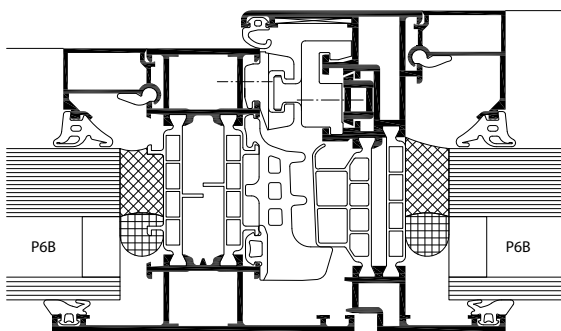

WICLINE 75 evo RC3

System test results / CE product pass in accordance with DIN EN 14351-1:2006+A1:2010

See classification of the respective WICLINE window series.



Technical performance:

Burglar resistance according to DIN EN 1627:

- The currently valid standard for burglar resistance, DIN EN 1627, has come into effect in European countries in 2011 and 2012. It replaced former national standards, like in Germany since September 2011 the standard DIN 1627. The classifications have been modified to classes RC1N to RC3, which are not identical with the former classes WK1 to WK3, as the test sequences have been changed.

Test results of the WICONA window series:

- The new WICLINE 65 evo and WICLINE 75 evo series with several variations have been tested according to the new standard DIN EN 1627. They can easily be specified and implemented without any additional measurement according to this new standard.

Burglar resistance according to DIN EN 1627 resp. DIN 1627 / classifications:

WICLINE 65 evo/75 evo Turn/tilt-turn/tilt/tilt-first/ double casement	RC1N, RC2N, RC2, RC3
WICLINE 65 evo/75 evo Fanlight	RC1N, RC2N, RC2, RC3
WICLINE 65 evo/75 evo Concealed sash	RC1N, RC2N, RC2, RC3
WICLINE 65 evo/75 evo Classic design	RC1N, RC2N, RC2, RC3
WICLINE 125 Coupled window	WK1, WK2, WK3