



WICTEC 50

Stick system curtain wall



WICTEC 50 is the basic version of the stick system façade, with an extra-narrow face width of 50 mm, inside and outside. The unique flexibility is demonstrated by the various system variants and enhancement options, all of which are feasible with minor additions to the system and without compromising on appearance.

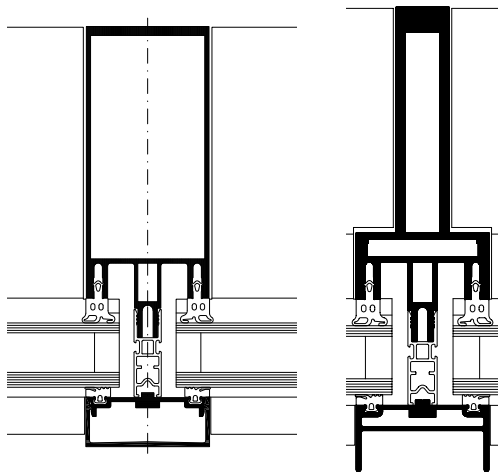

System test results / CE product pass in accordance with DIN EN 13830

Air permeability:	Class AE
Watertightness:	RE 1200
Resistance to wind load:	2000/-3200 Pa, security 3000/-4800 Pa
Sound insulation:	$R_w (C; C_{tr}) = 47 (-1; -4)$ dB
Impact resistance:	Class E5/I5
Burglar resistance:	RC1N, RC2N, RC2, RC3
Bullet resistance:	FB4
Quality assurance:	Certified according to ISO 9001:2008

Technical performance:

System width:	50 mm
Profile depth:	50 mm to 260 mm
Thermal insulation:	U_i value up to 1.2 W/(m ² K)
Infill thickness:	3 mm to 63 mm
Glass weight:	up to 5.6 kN
Polygon façade:	up to 45° (per side = 90° angle)
Roof pitch:	up to 10°

System technology:

- Ideal for vertical and polygon façades, sloped glazing and spatial structures
- Individual design thanks to a wide range of profile geometries for the structural and glazing profiles
- Alternative: Industrial design for technical look of steel profiles
- Reliable glass load transmission (up to 5.6 kN), with adapted transom-joint technology
- Overlapping and secure drainage at the cross point, without mechanical mullion processing, ensures tried-and-tested impermeability
- Filigree look without any change in appearance to the inner mullion and transom gaskets
- Broad selection of profiles enables economic adaptation to structural requirements, with the additional option of internal reinforcement
- Glazing from outside with visible or concealed screws
- Extensive solutions for structure junctions and conservatories

Additional options in identical design and technical set-up:

- Passive house curtain wall
- SG-design (integrated pressure profile)
- Structural glazing curtain wall
- Add-on curtain wall for steel and wood
- Integrated sun protection
- Fire protection curtain wall